



- Suspended continuous row lighting for LINEAR LED module, maximum 12 750 lumens
- CRI of 80
- MacAdam Ellipse : 3 SDCM
- Available in 3 000 K and 4 000 K
- Middle flux module 100 000 hours lamp life (L80B10), 50 000h (L90B10)
- High flux module 100 000 hours lamp life (L90B10)
- Luminous efficiency of system up to 186,5 lm/W
- Available in single module, in continuous row
- Housing made of prelacquered steel
- Cluster optical with lens, made of polycarbonate (PC)
- Endcaps and suspension brackets are available in accessories
- Optical compartment protected against shocks and dust
- Sliding suspension brackets, distance between brackets maximum 1 360 mm
- Mechanical junction without tools
- **Weight** : Approx. 4 kg
- **Standards housing lengths** : 1 246 mm et 1 360 mm
- **Driver(s)** : Fixed, Dimmable DALI (CDIMMDALI)
- **Option(s)** : Lighting sensor and-or movement detection (CEL), Independent Unit lighting Security (BAES)
- **Photobiological risk group 0**
- ENEC-labelled component and driver
- Red rendering (R9) : R9>50 (High flux), R9>0 (Middle flux)

Colour(s)



Light distribution

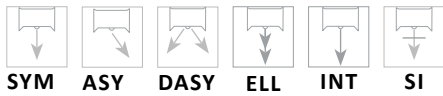

Accessories

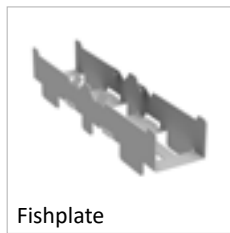

Assembly

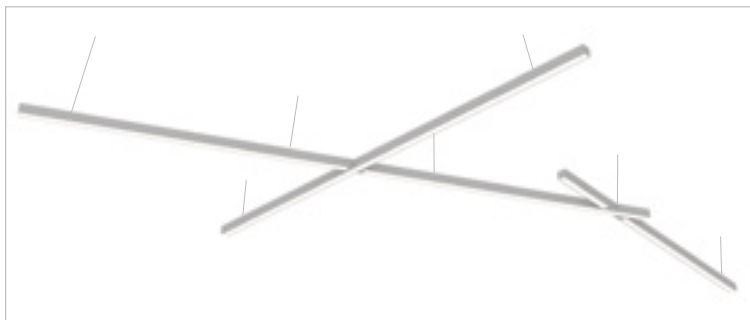

Driver(s)



Standards

Class I | IP 20 | 65° | IK 10 | RG0

Dimensions

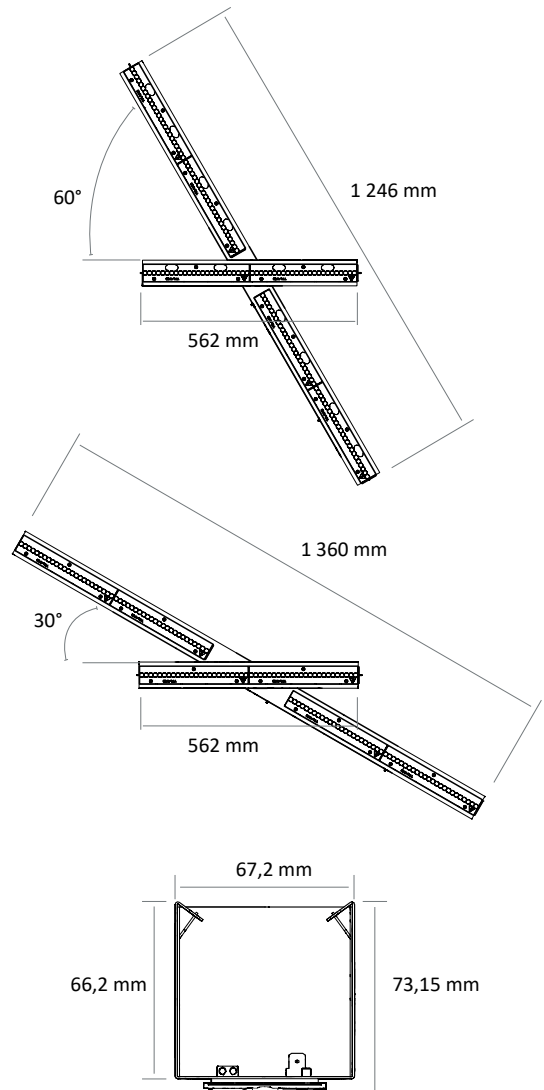

■ PERFORMANCES OF THE COMPONENTS HIGH FLUX

ITEM	NB OF MODULE(S)	CONSUMPTION	LUMINOUS FLUX	SYSTEM EFFICIENCY	COLOUR TEMPERATURE	CRI	EFFICIENCY ENERGY CLASS
LC 5183 LED H 4600 HE-830	2	26,5 W	4640 lumens	175 lm/W	3000 K	80	C
LC 5183 LED H 4600 HE-840	2	26,5 W	4740 lumens	178,7 lm/W	4000 K	80	C
LC 5183 LED H 6600 HE-830	3	38,1 W	6960 lumens	182,6 lm/W	3000 K	80	C
LC 5183 LED H 6600 HE-840	3	38,1 W	7110 lumens	186,5 lm/W	4000 K	80	C
LC 5183 LED H 7000-830	2	40,8 W	7100 lumens	173,6 lm/W	3000 K	80	C
LC 5183 LED H 7000-840	2	40,8 W	7240 lumens	177 lm/W	4000 K	80	C
LC 5183 LED H 8000-830	2	48,4 W	8340 lumens	172,1 lm/W	3000 K	80	C
LC 5183 LED H 8000-840	2	48,4 W	8500 lumens	175,4 lm/W	4000 K	80	C
LC 5183 LED H 10500-830	3	59,4 W	10650 lumens	179,1 lm/W	3000 K	80	C
LC 5183 LED H 10500-840	3	59,4 W	10860 lumens	182,6 lm/W	4000 K	80	C
LC 5183 LED H 12000-830	3	71,1 W	12510 lumens	175,7 lm/W	3000 K	80	C
LC 5183 LED H 12000-840	3	71,1 W	12750 lumens	179,1 lm/W	4000 K	80	C

■ PERFORMANCES OF THE COMPONENTS MIDDLE FLUX

ITEM	NB OF MODULE(S)	CONSUMPTION	LUMINOUS FLUX	SYSTEM EFFICIENCY	COLOUR TEMPERATURE	CRI	EFFICIENCY ENERGY CLASS
LC 5183 LED M 4600-830	2	26,4 W	4480 lumens	169,2 lm/W	3000 K	80	C
LC 5183 LED M 4600-840	2	26,4 W	4680 lumens	176,8 lm/W	4000 K	80	C
LC 5183 LED M 6600-830	3	38 W	6750 lumens	177,5 lm/W	3000 K	80	C
LC 5183 LED M 6600-840	3	38 W	7080 lumens	186,2 lm/W	4000 K	80	C
LC 5183 LED M 7000 HO-830	2	40,8 W	6840 lumens	167,6 lm/W	3000 K	80	C
LC 5183 LED M 7000 HO-840	2	40,8 W	7160 lumens	175,4 lm/W	4000 K	80	C
LC 5183 LED M 8500-830	3	48,8 W	8490 lumens	173,9 lm/W	3000 K	80	C
LC 5183 LED M 8500-840	3	48,8 W	8880 lumens	181,9 lm/W	4000 K	80	C
LC 5183 LED M 10500 HO-830	3	59,7 W	10260 lumens	171,7 lm/W	3000 K	80	C
LC 5183 LED M 10500 HO-840	3	59,7 W	10740 lumens	179,7 lm/W	4000 K	80	C

■ LIGHT DISTRIBUTION

Intensive :
LOR 90 %

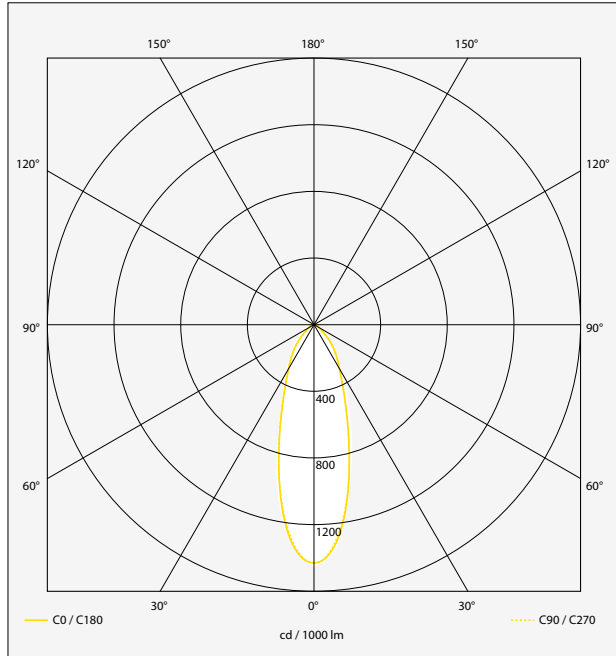

Mid-intensive :
LOR 96 %

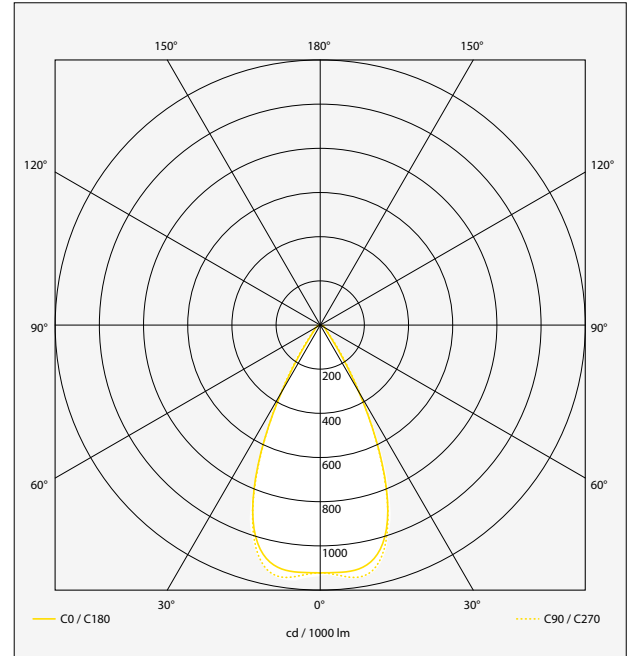

Elliptical :
LOR 96,5 %

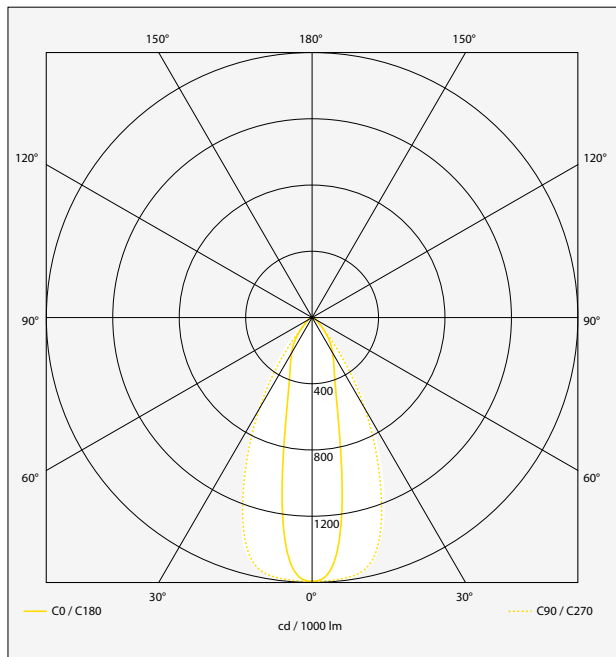

Symmetrical :
LOR 97 %

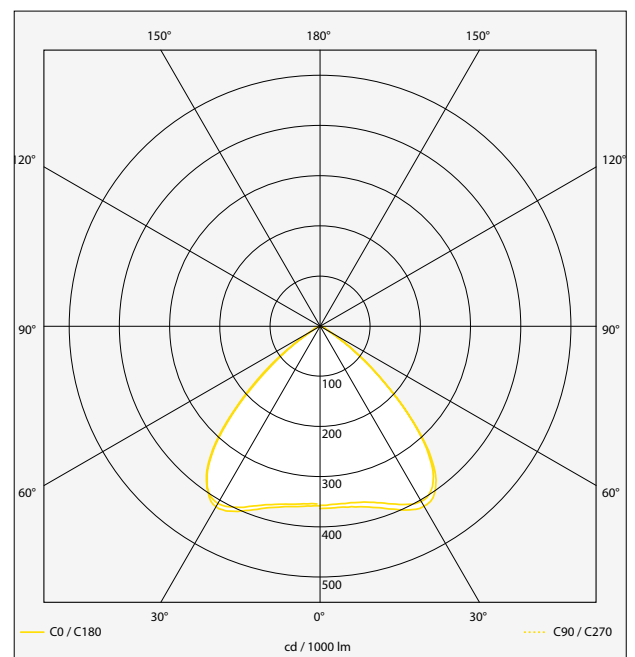

■ LIGHT DISTRIBUTION

Double Asymmetrical :
LOR 97 %



DASY

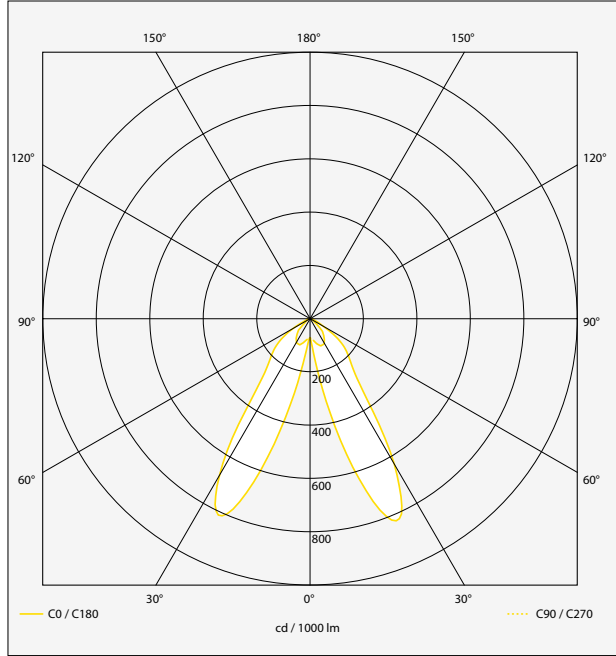

Asymmetrical :
LOR 92 %



ASY

